

Transfer Key

Model Series: TK

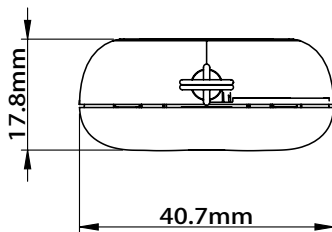

The Transfer Key is used to transfer information between the Acsys Lock and the Acsysware Management Software System. The primary role of the Transfer Key is to initialize/delete locks. The other usage is to download locks' access logs and transfer them to the database. Finally, the Transfer Key is used to blacklist lost keys used on the locks.

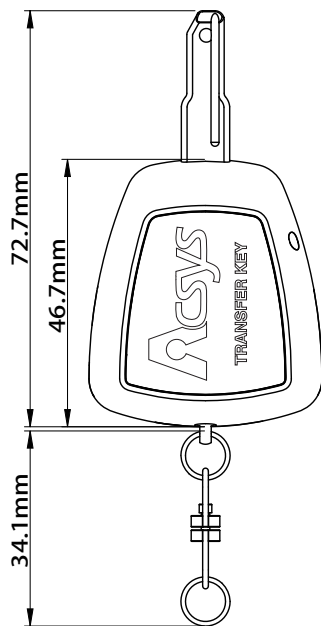

General	
Dimensions	40.7 x 72.7 x 17.8 mm
Material	BLADE SUS 316L / TOP COVER PC+25% GF / LED LENS / SWIVEL SUS 304
Environment Specifications	
Operating Temperature	-20 to 55 °C
Electronics	
Battery Type	2 x LR1 batteries
Battery Life	2 years
Encryption	AES 128bit
Visual Indicators	LED: 1 x Tri-color (Green, Red & Orange)
Compatibility	
Locks	All Acsys Lock Types
Compliance	
Quality Certification	CE, FCC, ROHS